

## Jackson County, Oregon Recorder's Office

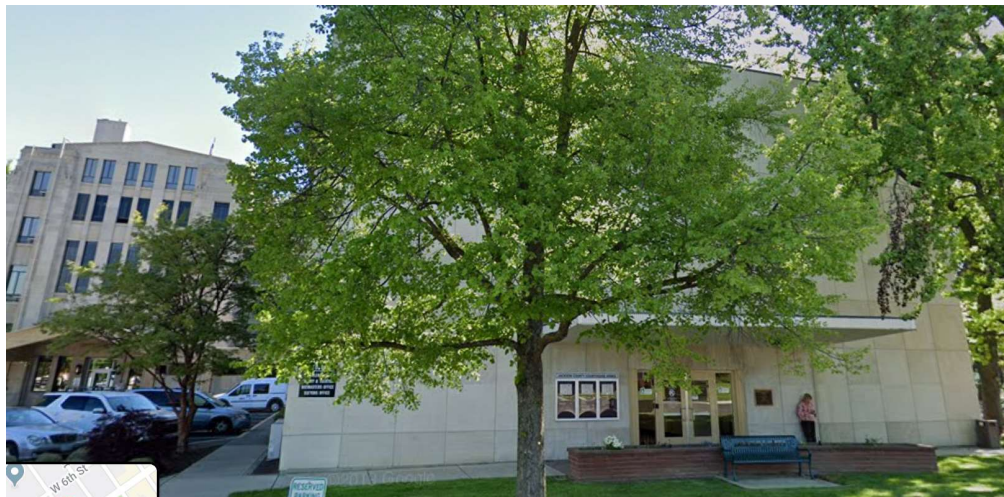

The Recorder's Office is in the Annex behind 10 Oakdale. It faces Laurel Street, and a free parking lot is on the other side of the street.



Home ownership after about 1950 may be traced online at <http://web.jacksoncounty.org/pdo/>  
This guide covers research for earlier deeds.

## Begin your search with your Deed Card

86-16-5		OFFICIAL RECORD OF RF 1 35547-4		OPERITIES 549-1	
ACCOUNT NUMBER 37 161 2986 6500		3716298606500 C4901		CODE NUMBER	
5-3		SECTION		86-16	
TAX LOT NUMBER		TOWNSHIP		AERIAL PHOTO	
LOT NO. 5		RANGE W.M. MAP NO.		Ankeny Heights	
BLOCK NO.		CITY		Medford	
LEGAL DESCRIPTION		DEED RECORD		ACRES	
EDWARDS, Donald R. & Barbara L.		7-19		319	
Bessouette, Jerry M. & Meredith G.		1957 444		319	
Welsh, Elizabeth G		1959 469 95		319	
Griebler, Bruce R. & Ann M		1962 532 370		319	
Griebler, Ann M (LE) & Griebler, Sharon Ann		1963 554 334		319	

Note the earliest volume and page.  
In this case:  
v444, p319

You could also search the other volumes and pages, but may not gain much more information from them

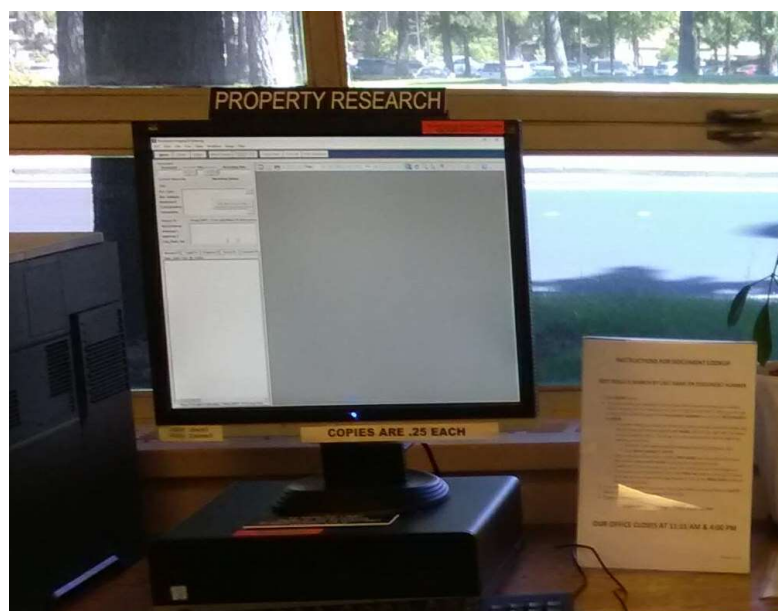

Use one of the Property Research computers to look up the deed information

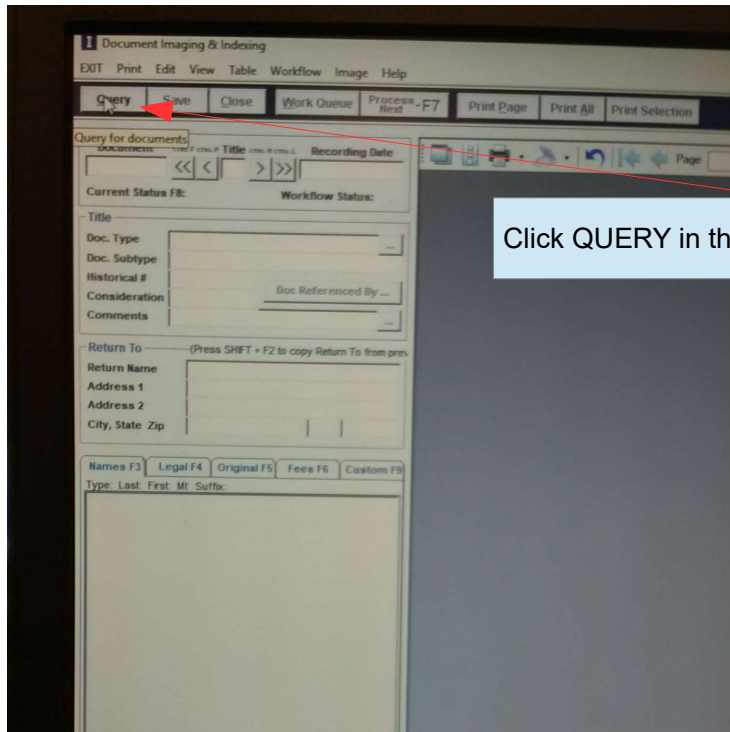

Click QUERY in the upper left corner

Document Imaging & Indexing

EXT Print Edit View Table Workflow Image Help

Query Save Close Work Queue Process Next F7 Print Page Print All Print Selection

Query for documents

Document: Title Recording Date

Current Status F8: Workflow Status:

Title

Doc. Type

Doc. Subtype

Historical #

Consideration

Comments

Return To (Press SHIFT + F2 to copy Return To from prev)

Return Name

Address 1

Address 2

City, State Zip

Names F3 Legal F4 Original F5 Fees F6 Custom F8

Type: Last First MI Suffix

Set Query Criteria

Document - F1

Year Document Number Range Title Recording Date Range

To To

Document Type By Code By Name

Document Subtype

Historical # V13 P166

☒ Include First Referenced Document

☐ Indexed Only ☐ Unverified Only

Name - F2

Last Name Name Type

☒ I.A. ☐ Direct ☐ Indirect

First Name Middle Name Name Suffix

Map - F3

Subdivision

Lot Block

Town Rng Sect QG Taxlot

Use a % sign as a wild card in any text field to find all records beginning with the entered text (Example: Enter Pet% to find all Petersens, Petasans, PetEones, etc.)

Begin Search Cancel Custom Index Search

In the Historical  
Number field, enter:  
V## p####  
(in this case,  
V13 P166)

Then click "Begin  
Search"



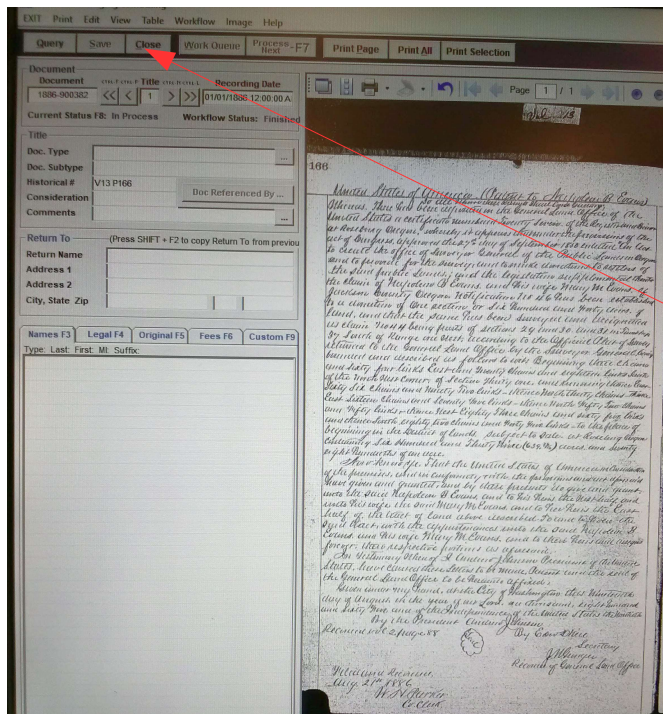

Older deeds are hard to read!  
You may want to print them out and pore over them later.

Use the Close option to move onto the next document

## Next Step, the Deed Indexes



Use the Index to Deeds Indirect to discover who your last known owner purchased the property from. You are looking up your last owner as the Grantee.

The oldest volumes cover recorded deeds through 1908

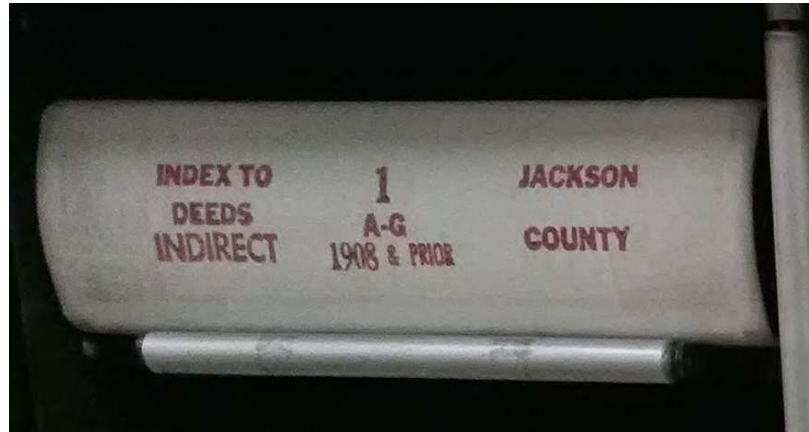

Look for the volume and page number for each transaction that seems relevant

INDEX TO DEEDS--INDIRECT. JACKSON COUNTY, OREGON.									
Year	First Given Name in Deeds Transcribed				Quarter (Party to Whom Deed is Given)	Quarter (Party Having Deed)	Volume of Instrument	Book	Page
	A B C D E F G H I J K L M N O P Q R S T U V W X Y Z								
30	Al				Evans	Boone	151		
31	Norris				"	Johnson, John	146		
32	"				"	Markus, William	171		
33	"				"	Robinson, Geo	2183		
34	Napoleon B				"	United States	2262		
35	Norris				"	Co School Supt.	2212		
36	"				"	Ambron, Geo W. E.	2244		

Note the Book number (same as volume number) and page number, then look them up on a Property Research computer. Repeat the process for previous owners until you have the chain of title for your home completed.

CROSSROADS: Once you have traced your home to its original owners, you could switch focus, or track the property's history

## Switch Focus

- Search for information on the previous home owners
- Explore building permits for your home
- Determine if others, such as renters, lived in the home

## Keep Searching

- Explore what is known about indigenous people in the area and their land use
- Determine first settlers on the property
- Work forward from the first settler to determine how land was divided and sold (this is hard!) The Research Guide on the homehist.com home page has hints

## MEDFORD BUILDING PERMITS

Begin with the Medford Land Information map

<https://gisapps.medfordmaps.org/mli/>

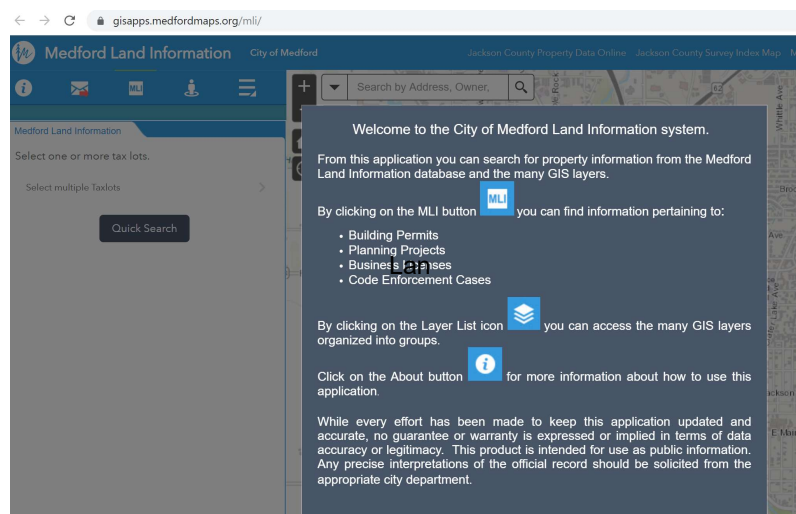

gisapps.medfordmaps.org/mlil/

**Medford Land Information** City of Medford Jackson County Property Data Online Jackson County Survey Index Map MLI Use Instructions

Search by Address, Owner,

**Medford Land Information**

Options Results

Maplot: 371W29BC6500  
 Acres: 0.27  
 Lot Sq Ft: 11761.2  
 Year Built: 1951  
 Improvement Value: \$80,890.00  
 Land Value: \$195,130.00  
 Owner Address: 63 EASTWOOD DR  
 MEDFORD, OR 97504  
 Tax Code: 4901  
 In City?:  
 Zoning: SFR-4  
 Zoning Overlays: A-C  
 Zoning Admin Mapping:  
 Comprehensive Plan: UR  
 Comp Plan Overlay:  
 Ward: 4  
 Fire District: MED  
 Building Permits: [BP07-02554](#)  
[BP10-01741](#)  
[BP15-01918](#)

63 EASTWOOD DR

Account: 10355474  
 Maplot: 371W29BC6500  
 Owner: HARPER PATRICIA A  
 Situs: 63 EASTWOOD DR  
[Zoom to](#)

On this page, you may access building permits issued after 1961.  
 Searching for earlier permits requires going through ledgers year by year.  
 The staff may ask you to make an appointment for this process.  
 (in other cities, contact the Building or Planning Department)

## Learn More about Previous Home Owners

**SOUTHERN OREGON HISTORICAL SOCIETY**  
 SINCE 1946  
 MAKING HISTORY TOGETHER

**Sohs.org**

About Us Collections SOHS Events Library Research Exhibits

Historians' Forum

**HANLEY FARM**  
 Est. 1857  
 SOUTHERN OREGON HISTORICAL SOCIETY

Online Catalog  
 Mega Index  
 Photos Index  
 Address Index  
 Eugene Bennett Archives  
 Frank Clark Inventory  
 Post Offices  
 Film List  
 Search Other Sites

The Mega Index and Photos Index may include references to your previous home owners.

The SOHS Address Index is an important resource that includes indexing for the historical surveys done in Jackson County, plus SOHS files

## SOHS and Public Libraries have city directories that can help you determine if your homeowners lived on the property, or renters lived there

### Polk's Medford and Ashland city directory: including Jackson County residents, 1939 -

Polk's Medford and Ashland **city directory**: including Jackson County residents, 1939

Record Type: Library

### Polk's Medford and Ashland, Oregon city directory; including Jackson County residents, 1942-1943 -

Polk's Medford and Ashland, Oregon **city directory**: including Jackson County residents, 1942-1943

Record Type: Library

### Polk's Medford and Ashland Oregon city directory: including Jackson County residents -

Polk's Medford and Ashland Oregon **city directory**: including Jackson County residents

## Newspapers are essential sources



Southern Oregon History,  
*Revised*





# Focus on Property History

Many deeds refer to Donation Land Claims and Land Patents.

View the original surveys: <https://glorerecords.blm.gov/search/default.aspx>

U.S. DEPARTMENT OF THE INTERIOR  
**BUREAU OF LAND MANAGEMENT** PRIVATE CLAIMS  
General Land Office Records

Search Documents Reference Center Support Shopping Cart

Search Documents

Search Documents By Type Search Documents By Location Search Documents By Identifier

Patents Surveys LSR CDI Tract Books

Search

Location  
State: ALABAMA  
County: Any County

Names  
Last Name:  
First Name:  
Middle Name:  
☐ search patentees ☐ search warrantees

Land Description  
Township: /  
Range: /  
Meridian: Any Meridian  
Section #:

Miscellaneous  
Land Office: Any Land Office Issue Date: to  
Document #: Militia:  
Indian Allot #: Tribe: Any Tribe  
Survey #: Geo. Name/  
Authority: Any Authority Mining Claim:

To search for land patents:  
1. Start by selecting the State.  
2. You do not have to fill in all fields, but provide at least one additional field.  
3. Click the Search Patents button.

Search Tips:  
• Hover your mouse over a field to get a brief description.  
• Get detailed information by checking the Glossary in the Reference Center.  
• For more tips and help, check out our Patent Search Overview.

Note: This site does not cover every state, but we do have resource links for most states.

Search Patents

Enter state, county, name if you know it, township, range if you have that information

U.S. DEPARTMENT OF THE INTERIOR  
**BUREAU OF LAND MANAGEMENT** PRIVATE CLAIMS  
General Land Office Records

Search Documents Reference Center Support Shopping Cart

Search Documents

Search Documents By Type Search Documents By Location Search Documents By Identifier

Patents Surveys LSR CDI Tract Books

Search

Location  
State: OREGON  
County: Any County

Names  
Last Name: Evans  
First Name: Napoleon  
Middle Name:  
☐ search patentees ☐ search warrantees

Land Description  
Township: /  
Range: /  
Meridian: Any Meridian  
Section #:

Miscellaneous  
Land Office: Any Land Office Issue Date: to  
Document #: Militia:  
Indian Allot #: Tribe: Any Tribe  
Survey #: Geo. Name/  
Authority: Any Authority Mining Claim:

To search for land patents:  
1. Start by selecting the State.  
2. You do not have to fill in all fields, but provide at least one additional field.  
3. Click the Search Patents button.

Search Tips:  
• Hover your mouse over a field to get a brief description.  
• Get detailed information by checking the Glossary in the Reference Center.  
• For more tips and help, check out our Patent Search Overview.

Note: This site does not cover every state, but we do have resource links for most states.

Search Patents

U.S. DEPARTMENT OF THE INTERIOR

BUREAU OF LAND MANAGEMENT

PRIVATE CLAIMS

General Land Office Records

Search Documents

Reference Center

Support

Shopping Cart

Search Documents

Results List

Patents

Note: An *Italic* entry denotes data that has not been indexed against the land patent document, and has no image.

Image	Accession	Names	Date	Doc #	State	Meridian	Twp - Rng	Aliquots	Sec. #	County
---	<i>ORRAA 004083</i>	<div>EVANS, MARY M.</div> <div>EVANS, NAPOLEON B</div>	8/19/1865	27	OR	Willamette	037S - 001W		29	Jackson
							037S - 001W		30	Jackson
							037S - 001W		31	Jackson

USA GOV

No Fear Act

DOI

Disclaimer

About BLM

Notices

Get Adobe Reader

Privacy Policy

FOIA

Kids Policy

Contact Us

Accessibility

Site Map

Home

This isn't a very helpful page

Names On Document

EVANS, MARY M.

EVANS, NAPOLEON B

Military Rank: ---

Miscellaneous Information

Land Office: Roseburg

US Reservations: No

Mineral Reservations: No

Tribe: ---

Militia: ---

State In Favor Of: ---

Authority: September 27, 1850: Oregon Donation Act (grant) (99 Stat. 496)

General Remarks: ---

Document Numbers

Document Nr: 27

Misc. Doc. Nr: ---

BLM Serial Nr: ORRAA 004083

Indian Allot. Nr: ---

Coal Entry. Nr: ---

Survey Information

Total Acres: 639.78

Survey Date: ---

Geographic Name: ---

Metes/Bounds: No

Land Descriptions

Map	State	Meridian	Twp - Rng	Aliquots	Section	Survey #	County
<input checked="" type="checkbox"/>	OR	Willamette	037S - 001W		29	44	Jackson
<input checked="" type="checkbox"/>	OR	Willamette	037S - 001W		30	44	Jackson
<input checked="" type="checkbox"/>	OR	Willamette	037S - 001W		31	44	Jackson

## Determine your township and range, then search the Surveys section

U.S. DEPARTMENT OF THE INTERIOR  
**BUREAU OF LAND MANAGEMENT** PRIVATE CLAIMS General Land Office Records

Search Documents Reference Center Support Shopping Cart

Search Documents

Search Documents By Type Search Documents By Location Search Documents By Identifier

Patents  
Surveys  
LSR  
CDI  
Tract Books

Search

Location

State: OREGON  
County: Any County

Land Description

Township: 37 / South  
Range: 1 / West  
Meridian: Any Meridian

To search for surveys

1. Start by selecting the state.
2. **You do not have to fill in all fields**, but provide *at least* one additional field.
3. Click the **Search Surveys** button.
4. You will be switched to the "Search Results" page.

You can get a brief description of what each field means by hovering your mouse over it. You can get more detailed information by checking the [Glossary](#) in the Reference Center. For more tips and help, check out our [Survey Search Overview](#).

Miscellaneous

Survey Type: Any Survey Type Contract/Group Nr: Survey Nr:  
Surveyor: Any Surveyor Approved Date: to

Search Surveys

Note: This site does not cover every state. We do have [resource links](#), though, for most states.

## View the 1855 and the 1858 Surveys

U.S. DEPARTMENT OF THE INTERIOR  
**BUREAU OF LAND MANAGEMENT** PRIVATE CLAIMS General Land Office Records

Search Documents Reference Center Support Shopping Cart

Search Documents Results List

Printer Friendly

Survey	Approved / Accepted	State	Meridian	Twp - Rng	Boundaries / Subdivisional	County	Field Notes
<a href="#">Original Survey</a>	1/16/1855	OR	Williamette	037.0S - 001.0W	---	Jackson	<a href="#">Plot Image</a> -
<a href="#">Original Survey</a>	4/12/1858	OR	Williamette	037.0S - 001.0W	---	Jackson	<a href="#">Plot Image</a> -
<a href="#">Diagram</a>	3/30/1863, 6/12/1865	OR	Williamette	037.0S - 001.0W	---	Jackson	<a href="#">Plot Image</a> -
<a href="#">Dependent Resurvey and Subdivision of Sections</a>	11/9/2006	OR	Williamette	037.0S - 001.0W	---	Jackson	<a href="#">Plot Image</a> -
<a href="#">Original Survey</a>	3/28/2008	OR	Williamette	037.0S - 001.0W	---	Jackson	<a href="#">Plot Image</a> -

USA.GOV | No Fear Act | DOI | Disclaimer | About BLM | Notices | Get Adobe Reader®  
Privacy Policy FOIA Kids Policy Contact Us Accessibility Site Map Home

Select Plat Image, and there it is!

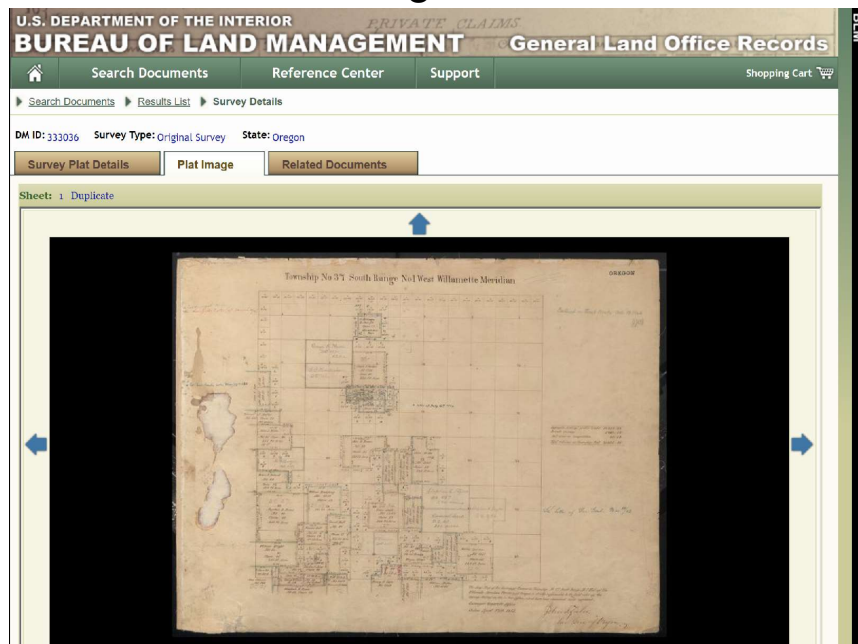

Zoom in to view details

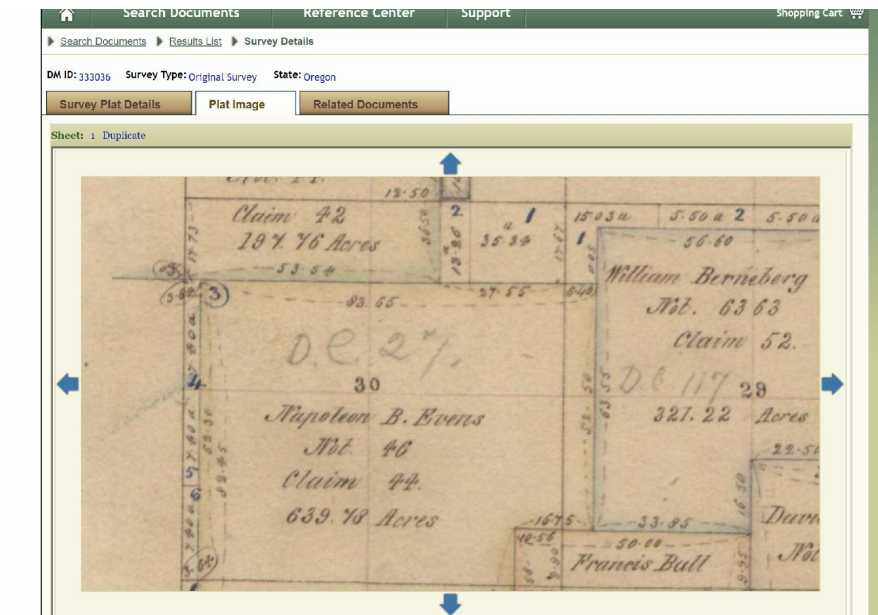



## View DLC outlines on a modern map?

- Jackson County Survey map:  
<http://jacksoncountyor.org/surveyor/Survey-Index-Map>

**JACKSON COUNTY**  
*Surveyor*

**SURVEYOR'S OFFICE**  
Jackson County Courthouse  
10 South Oakdale, Room 318  
Medford, Oregon 97501  
(541) 774-6191

HOME ABOUT SERVICES **SURVEY INDEX MAP** CONTACT

→ You are here : Survey Index Map

September 17, 2019

**Survey Index Map**

This index map is only provided by the Jackson County Surveyors office to assist in locating recorded county surveys. For questions or comments regarding the completeness or functionality of this map, please contact the Jackson County Surveyor's office at [541-774-6191](tel:541-774-6191).

**Getting Started**

**Basemaps:** You can choose a basemap in the upper right hand corner of the map or keep the default topographic map.

**Zooming and Panning:** There are various ways to zoom. With the mouse wheel, scroll up to zoom in and scroll down to zoom out. Hold shift, click, and drag will create a zoom box. Double click. Use the zoom tools in the upper left hand side. You can similarly pan through the map using the mouse by clicking and dragging, or by using the tools in the upper left hand side.

[Launch Interactive Map](#)  
**NOTE: Opens in a new window**



## Open the map, then limit the layers

The brown outlines are Donation Land Claim boundaries. Zoom out to view the complete outline, zoom in to view the DLC number.

**Survey Index Map 2.0** [Click here for help](#)



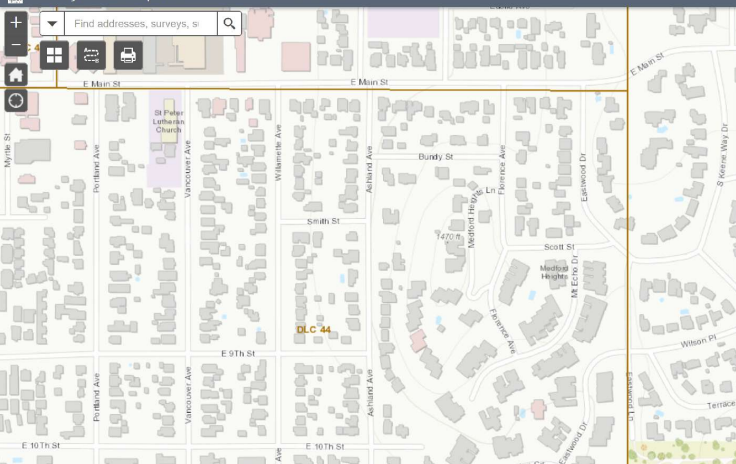

**Layer List**

**Layers**

☒ Survey Indexing Version 2.0

☐ PLSS Labels

☐ Townships

☐ Sections

☐ County Surveys

☒ Special Survey

☒ Meandered Water

☐ Taxlots

To look up a Donation Land Claim by its number, email or visit the Southern Oregon Historical Society Library and request the Donation Land Claim book (929 G45 1962 ). This will provide the name(s) of the grantees and sometimes provide details about them.